

# D SERIES ACCESS CONTROL

## D Series Stainless Steel Luminous Exit Button

Model: AE-DBML-43

### Specs

Operating Voltage	9-13V DC
Material	Zink Alloy
Mechanical Life	1,000,000 Test
Mounting	Flush Mounting
Output Contact	NO, NC, COM

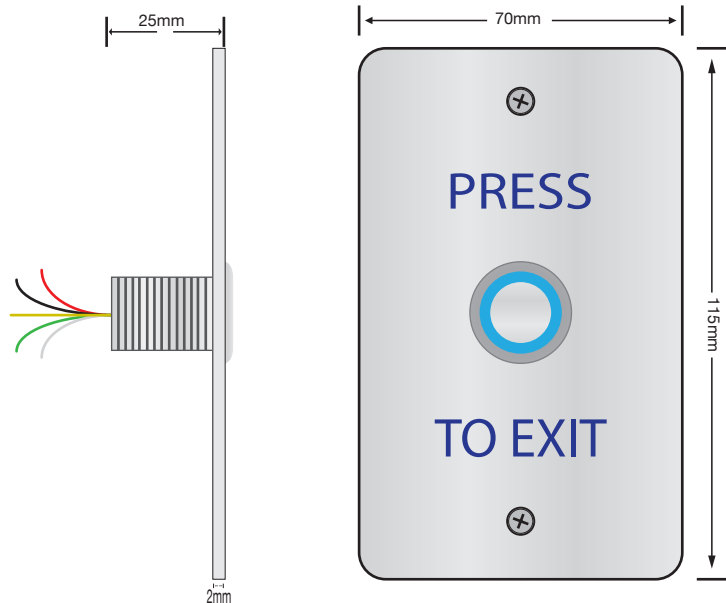

### Cable Diagram

- **+12vDC:** This cable is the 12vDC input to provide power to the illumination.
- **GRD:** This cable provides Ground to the illumination.
- **COM:** This cable receive's signal from a device.
- **NO:** This cable sends the signal when the button is pressed.
- **NC:** This cable releases the signal when the button is pressed.

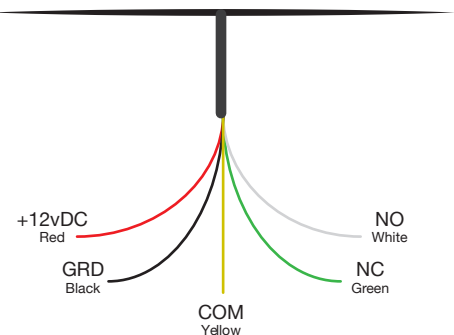

## Connecting to D Series AC Board

To connect this Push to Exit Button to the D Series Access Control board please connect the following wires to the corresponding ports.

**Red** Wire = +12vDC Port

**Black** Wire = GRD Port

**White** Wire = GRD Port

**Yellow** Wire = PX Port

The **Red** and **Black** wires can alternatively be connected to the Access Control power supply directly if preferred.

