

Z-HE2EMNCW12-S

2MP 12x Starlight PTZ HDCVI Camera



- 1/2.8" 2Megapixel STARVIS™ CMOS
- Powerful 12x optical zoom
- Starlight technology
- Max. 25/30fps@1080P, 25/30/50/60fps@720P
- 120dB true WDR, 3D DNR
- IP66, IK10



Functions

HD-over-Coax

HD-over-Coax is a new analog high definition (HD) video standard transmitting over coaxial cable. The technology provides transmission of HD video as well as audio, and two-way control data over long distances. You can implement an HD system using the same coax cables that your existing analog system is running on. HD-over-Coax installs just like analog cameras and gives you up to 1080p High Definition. No fiber, no configuring, and no special training required.

Starlight

The starlight standard sensor is just like the retina of your eyes which is sensitive to its ambient light, and the image quality is determined by how much light the sensor could use, together with the camera lens. The starlight camera technology uses larger and highly sensitive sensors, wider aperture and reduces the shutter speed to collect enough light for sharp monochrome/color images, even when human eyes couldn't identify a thing. So the starlight camera can see right through the darkness, even when it is challenging for your eyes.

Wide Dynamic Range

When part of an image is extremely dark but another part is so bright you can't see any details, that's dynamic range—the difference in lighting. Cameras with wide dynamic range (WDR) have special software that allows them to balance that lighting for one clear image. This makes them ideal for recording areas like store entrances where the contrast between the sunshine outside and the dim lighting inside can be extremely difficult to record.

IP66 & IK10 Protection

IP66 refers to camera enclosures that have obtained the a rating from the International Electrotechnical Commission's (IEC) international standard 60529 rating board that declares the cameras to be: Offering full protection from dust and solid matter larger than dust. IK10 cameras are Protected against a 5 Kg object dropped from 40 cm in height

Z-HE2EMNCW12-S

Technical Specification			
Camera			
Image Sensor	1/2.8" STARVIS™ CMOS		
Effective Pixels	1920(H) x 1080(V), 2 Megapixels		
Scanning System	Progressive		
Electronic Shutter Speed	PAL: 1/3s~1/30,000s NTSC: 1/4s~1/30,000s		
Minimum Illumination	Color: 0.005Lux@F1.6; B/W:0.0005Lux@F1.6		
S/N Ratio	More than 50dB		
IR Distance	N/A		
IR On/Off Control	N/A		
IR LEDs	N/A		
Lens			
Focal Length	5.3mm~64mm		
Max. Aperture	F1.6 ~ F3.0		
Angle of View	H: 58.2° ~ 4.8°		
Optical Zoom	12x		
Focus Control	Auto/Manual		
Close Focus Distance	100mm~ 1000mm		
DORI Distance			
*Note: The DORI distance is a “general proximity” of distance which makes it easy to pinpoint the right camera for your needs. The DORI distance is calculated based on sensor specification and lab test result according to EN 62676-4 which defines the criteria for Detect, Observe, Recognize and Identify respectively.			
Detect	Observe	Recognize	Identify
883m(2897ft)	353m(1158ft)	177m(581ft)	88m(289ft)
PTZ			
Pan/Tilt Range	Pan: 0° ~ 360° endless; Tilt: -2° ~ 90°,auto flip 180°		
Manual Control Speed	Pan: 0.1° ~300° /s; Tilt: 0.1° ~120° /s		
Preset Speed	Pan: 300° /s; Tilt: 200° /s		
Presets	300		
PTZ Mode	5 Pattern, 8 Tour, Auto Pan ,Auto Scan		
Speed Setup	Human-oriented focal Length/ speed adaptation		
Power up Action	Auto restore to previous PTZ and lens status after power failure		
Idle Motion	Activate Preset/ Scan/ Tour/ Pattern if there is no command in the specified period		
Protocol	DH-SD, Pelco-P/D (Auto recognition)		
Video			
Resolution	1080P(1920×1080)/720P(1280×720)		
Frame Rate	25/30fps@1080P, 25/30/50/60fps@720P		
Video Output	1-channel BNC high definition video output/ CVBS standard definition video output (switchable)		

Day/Night	Auto(ICR) / Color / B/W
OSD Menu	Support
Backlight Compensation	BLC / HLC / WDR(120dB)
White Balance	Auto, ATW, Indoor, Outdoor, Manual
Gain Control	Auto / Manual
Noise Reduction	Ultra DNR (2D/3D)
Digital Zoom	16x
Flip	180°
Privacy Masking	Up to 24 areas
Certifications	
Certifications	CE: EN55032/EN55024/EN50130-4 FCC: Part15 subpartB,ANSI C63.4- 2014 UL: UL60950-1+CAN/CSA C22.2, No.60950-1
Interface	
Video Interface	1
Audio Interface	1 channel in
RS485	1
Alarm I/O	2/1
Electrical	
Power Supply	AC24V/1.5A(±10%)
Power Consumption	10W
Environmental	
Operating Conditions	-30°C ~ 60°C (-22°F ~ +140°F) / Less than 95% RH
Ingress Protection	IP66
Vandal Resistance	IK10
Construction	
Casing	Metal
Dimensions	Φ170(mm)×155(mm)
Net Weight	1.8kg(3.97lb)
Gross Weight	3.3kg(7.28lb)

Z-HE2EMNCW12-S

Accessories

Included:



AC24V/1.5A
Power Adapter

Optional:



WEW-302S
Wall Mount



MEN-102
Mount Adapter



IEW-300C
Ceiling Mount



LEW-150
Pole Mount



CEW-151
Corner Mount

Dimensions (mm)

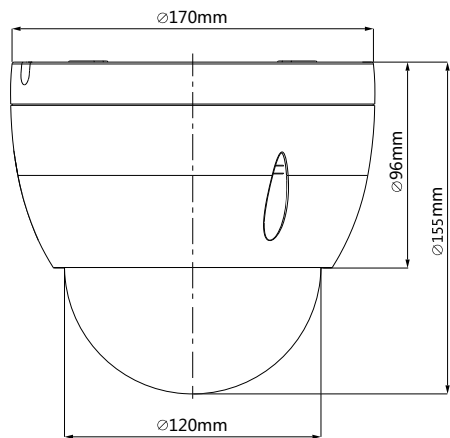

Ceiling Mount	Wall Mount
MEN-102+ IEW-300C	MEN-102 + WEW-302S
Pole Mount	Corner Mount
MEN-102+ WEW-302S + LEW-150	MEN-102+ WEW-302S + CEW-151